



alpine-property

Alpine Property SAS au capital de 3 450 € - RCS Thonon les Bains 508 578 556 - siège: 153 chemin du Chargeau, 74110 Morzine, France - Titulaire de la Carte Professionnelle n° CPI 7401 2016 000 017 391 délivrée par la CCI de la Haute Savoie

Tel: +44 (0)208 123 2384

Email: info@alpine-property.com

Web: www.alpine-property.com

Appt. Yeti, 184

Chatel, Châtel & Vallée, Portes Du Soleil

350 000 €uros



Contact

Contact **Ed Ockelton** about this property.

Tel: +33 6 77 83 19 98

Email: ed@alpine-property.com

Key Features

Price	350 000 Euros
Status	SOLD
Last updated	09/11/2023
Area	Portes Du Soleil
Location	Châtel & Vallée
Village	Chatel
Bedrooms	2
Bathrooms	1
Floor area	49.9 m²
Heating	Electric radiators
Chimney	Open fire
Nearest skiing	190 m
Nearest shops	170 m
Garage	Single
Drainage	Mains drains
Number of lots	24
Procédure en cours	No
Energy efficiency rating	E (312)
CO2 emissions	B (9)
Agency fees	Paid by the seller

Property Description

Yeti apartment 184 is a spacious (49.93 sq m habitable/52.12 sq m total), well maintained apartment which has had a lot of recent modernisation.

Located in the desirable Petit Chatel area of the village, the apartment benefits from panoramic views and lots of sunshine. It is also a short walk from the chairlift in Petit Chatel, and the ski bus stops close by.

Laid out over two floors, on the main floor the apartment has a wide entrance hall with lots of storage (previously this was a "coin montagne" sleeping area with bunkbeds and can be used as such again if required), a modern shower room and WC and a light, open plan living, dining kitchen area with modern kitchen. Upstairs is a mezzanine double bedroom area, and a further double bedroom.

The property also comes with a designated parking space in the underground garage, a large cave and two ski lockers.

Overall, a lovely ready-to-go apartment in an excellent location.

The property is covered by the copropriété rules.



REZ-DE-CHAUSSEE

SIZES AND DIMENSIONS ARE APPROXIMATE, ACTUAL MAY VARY

DoorInsider

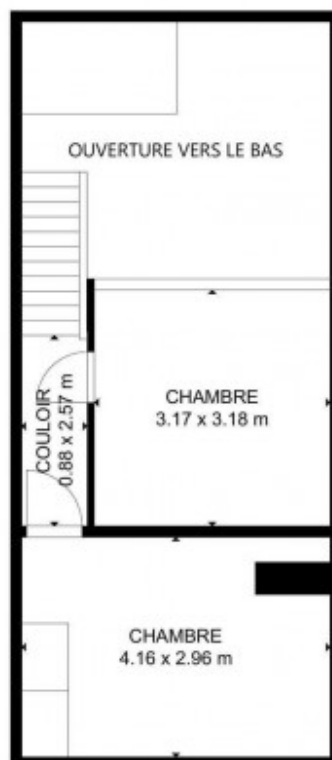

1ER ÉTAGE

SIZES AND DIMENSIONS ARE APPROXIMATE, ACTUAL MAY VARY

DoorInsider













